

Gatton Campus 2018 PARKING MAP

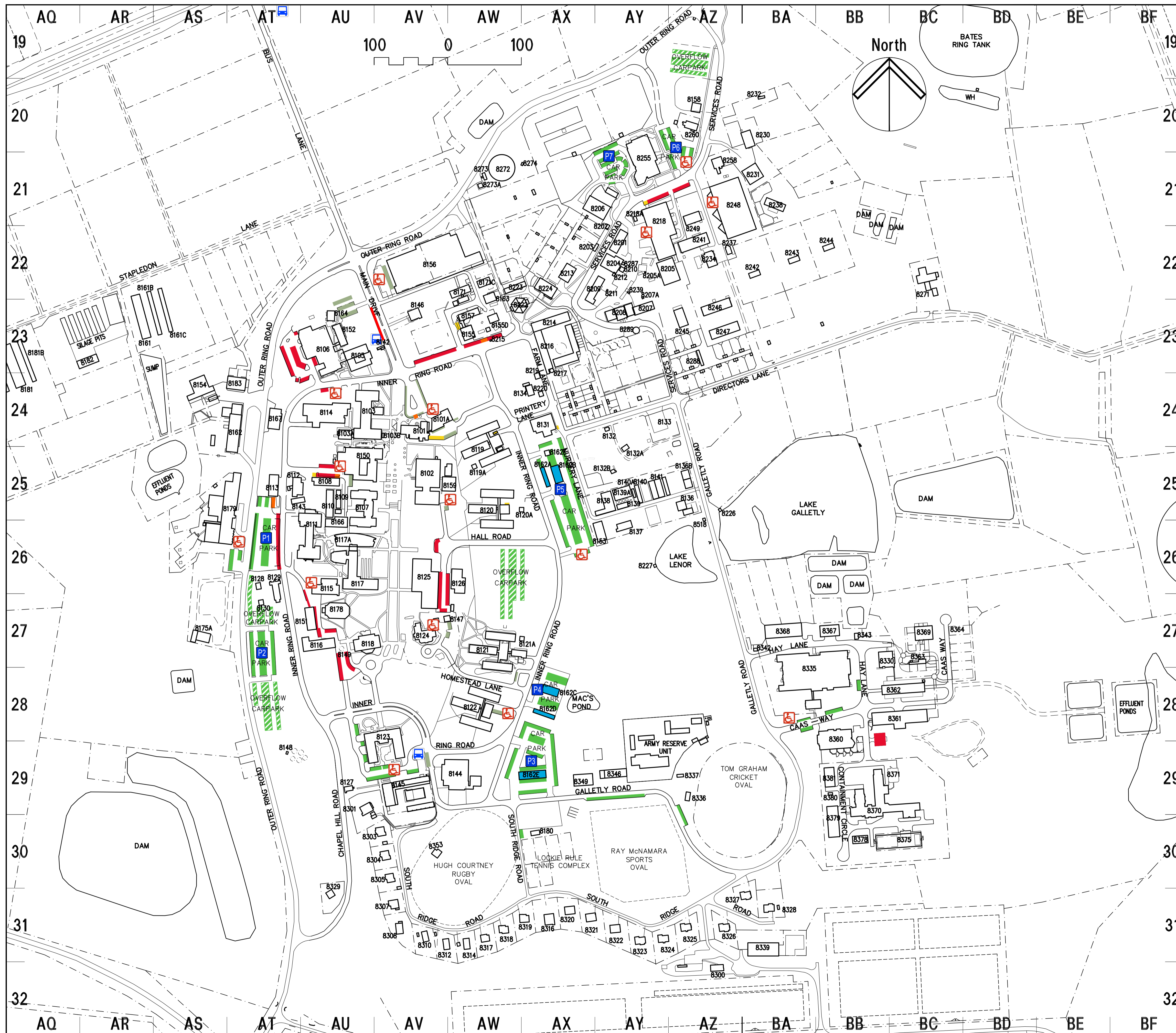

NO.	BUILDING NAME	MAP REF.
8108	Agricultural Chemical Application & Safety	AU-25
8115	Agricultural Mechanisation A	AU-27
8116	Agricultural Mechanisation B	AU-27
8151	Agricultural Mechanisation C	AU-27
8103A	Animal Health Laboratory	AV-25
8103	Animal Industries	AV-24
8150	Animal Studies	AV-25
8113	Australian Seed Technology Education Centre	AU-25
8226	Bird Hide 1	BA-26
8227	Bird Hide 2	AZ-26
8349	Bosworth Relaxation Centre	AY-29
8369	Bovine Clinic & Teaching Facility	BC-27
8142	Bus Shelter - Main Drive	AV-23
8517	Bus Shelter - Warrego Highway	AT-19
8127	Chapel	AV-30
8179	Clinical Studies Centre	AT-26
8132	Community Gardens	AY-24
8159	Computer Annexe	AW-25
8171	CSIRO Building	AW-22
8162	Dairy Complex	AT-24
8154	Dairy Research Unit	AT-24
8125	Dining Hall	AW-27
8126	Distance Education Centre	AW-27
8206	Elton Burns Recreation Building	AY-22
8518	Environmental Precinct Information Booth	AY-22
8224	Equine Reproduction Facility	AX-23
8163	Equine X-Ray Building	AW-23
8214	Farm Services Building	AX-23
8216	Farm Square - Horse Stalls	AX-23
8118	Foundation Building	AU-27
8152	Gatton Campus Motel	AU-23
8153	Grounds Maintenance Shed	AY-26
8339	Hay Shed Macarthur	BA-31
8124	Homestead	AW-27
	Hugh Courtney Rugby Oval	AW-30
8102	J.K. Murray Library	AW-25
8218	Jack Jones Building	AZ-22
8105	John Mahon Stage I	AV-24
8106	John Mahon Stage II	AU-24
8248	Library Warehouse	AZ-21
	Lockie Rule Tennis Complex	AX-30
8136	Lysimetry Facility	AZ-25
8178	Main Lecture Theatre	AU-27
8117	Management Studies Building	AV-27
8146	Medical Centre Annexe	AV-23
8134	Merv Young "White House"	AX-24
8123	Morrison Hall	AV-29
8128	Muslim Prayer Room	AT-27
8238	Native Wildlife Teaching And Research Facility	BA-21
8117A	NRSM Building	AV-26
8101A	N.W. Briton Administration Annexe	AW-24
8101	N.W. Briton Administration Building	AW-25
8157	Nyamul Child Care Centre - Free Range Kids Gatton	AW-23
8164	Peter Roberts Continuing Education Centre	AU-23
8335	Piggery Unit	BB-28
8121	Pitt Hall of Residence	AX-28
8112	Plant & Soil Facility	AU-25
8111	Plant Industries	AU-26
8138	Plant Nursery Building	AY-26
8166	Plant Pathology Building	AU-26
8107	Plant Protection Building	AV-27
8258	Poultry Unit Main Office	BA-21
8131	Printery	AX-24
8360	QASP - Central Support	BB-28
8346	Ray Bills Cadet Training Centre	AZ-29
	Ray McNamara Sports Oval	AZ-30
8133	Resource Recycling Centre	AY-24
8119	Riddell Hall of Residence	AX-25
8230	Shearing Teaching Building	BA-21
8122	Shelton Hall of Residence	AW-28
8129	Sir Leslie Wilson Hall	AU-27
8300	Solar Research Facility	AZ-32
8180	Tennis Pavilion	AX-30
8120	Thynne Hall of Residence	AX-26
	Tom Graham Cricket Oval	BA-30
8175	Tractor Training Compound	AT-27
8209	Transport Building	AY-23
8156	UQ Veterinary Medical Centre	AV-22
8114	Veterinary Science Building	AU-24
8255	W.P. Harmon Memorial Centre	AZ-21
8144	War Memorial Gymnasium & Squash Courts	AW-29
8145	War Memorial Swimming Pool	AV-30
8143	Wilderness Reserves and Wildlife	AU-26
8231	Wool Store	BA-21

- UNDERCOVER PERMIT PARKING
- STAFF PARKING
- VISITOR PARKING
- RESTRICTED PARKING
- GENERAL PARKING
- GENERAL PARKING (OVERFLOW CARPARK)
- MOTORCYCLE ZONE
- ADPP PARKING
- BUS SET DOWN
- YELLOW LINES - No Parking